

Angle Joint Adapter



Instruction Manual

ROTH **MOBELI®** Angle Joint Adapter

REF 1400558

as accessory for mobile adjustable 2-hand telescopic handles

Order no. 14002 21S, 14002 22S und 14002 23S:

Table of contents

1. General	2
1.1 General information	2
1.2 Explanations/symbols in the manual and on the handle	2
1.3 Intended use and application range	2
1.4 Useful life	2
1.5 Reuse	2
2. Safety information	2
3. Operation / mounting	3
3.1 Mounting / assembling	3
3.2 Assembly examples	3
3.3 Disassembling	3
4. Technical data	4
4.1 Markings on the product	4
4.2 Dimensions and weights	4
4.3 Materials	4
5. Maintenance	4
5.1 Maintenance (cleaning/disinfection)	4
5.2 Maintenance (service)	4
6. Malfunctions	4
7. Disposal	4



1. General

1.1 General information



Before using, be sure to carefully read these instructions for use and the instructions for use of the QuattroPlus grab handle (if not available, please request them!) and follow the safety instructions. Keep these instructions for future reference and pass them on to other users!

1.2 Explanations/symbols in this manual and on the handle

	Follow the instructions for use! (ISO 7010; M002)
	For persons with visual impairment, the font size for this on-line manual can be set accordingly at https://www.mobeli.de/download-bereich .
	Warning (indicates a dangerous situation)
	Manufacturer (additionally, year of manufacture on the handlebar)
REF	Order number
	Maximum user weight
CE	The mobile MOBELI grab handles are compliant with Regulation (EU) 2017/745
MD	The mobile MOBELI grab handles are Class I medical devices
LOT	Batch designation

1.3 Intended use and application range



The angle joint adapter may only be used as accessories for grab handles **1400221S, 22S, and 23S**. The angle joint adapter increases the flexibility of these grab handles for largely independent use of shower, bath tub, toilet, and washbasin. The angle joint adapter can be quickly clipped on for corner use.



Attention! The handle must not be used as a seat. Any other use, e.g. as a seat, carrying handle or climbing aid, is not permitted.

1.4 Useful life

The expected service life is six years (if used daily and as intended) in a hospital or other institution. The prerequisite for this is compliance with the maintenance and safety regulations specified in these operating instructions. The actual service life may vary depending on the frequency and intensity of use. These handles have been tested according to ISO 17966:2016.

1.5 Reuse

The product is suitable for repeated use. How often the product can be used depends on the type of use. Clean, disinfect and check the product thoroughly before re-use.

2. Safety information

- Prior to each use of the grab handle with the angle joint adapter, the instructions for the QuattroPlus grab handle must be followed.
- **Maximum user weight of the QuattroPlus grab handles is reduced to 75 kg when using the angle joint adapter!**
- The angle joint adapter may only be in fully functional QuattroPlus grab handles.
- Damaged stickers must be replaced.

3. Operation / assembly

3.1 Mounting / assembling

First, clip the bar out of the handle (see operating information for mobile grab handle).



1
Push in the snap-lock pin of the telescopic handle and insert it into the angle joint adapter.



2
Then push in the snap-lock pin of the angle joint adapter and slide it into the suction head.



The QuattroPlus handle with the angle joint adapters may only be used when the snap-lock pins are firmly locked. Be sure to pull at the handle after assembly to check that it is securely held.

3.2 Mounting examples for the 2-Hand-Telescopic-grab handles with angle joint adapter as an asseccoires



The 2-hand telescopic holding handles (order no.: 2) are attached to the angle joint adapter. No. 14002 21S, 22S, 23S) can be used even more universally. Thanks to the quickly clip-on angle joint adapters, the handles can now also be positioned at unfavourable corners. If the angled joint adapter is no longer needed, it can simply be removed again and prepared for the next problem solution.

→ Corner use - in the glass shower, bridging washbasin.



→ unevenness in the bathtub or

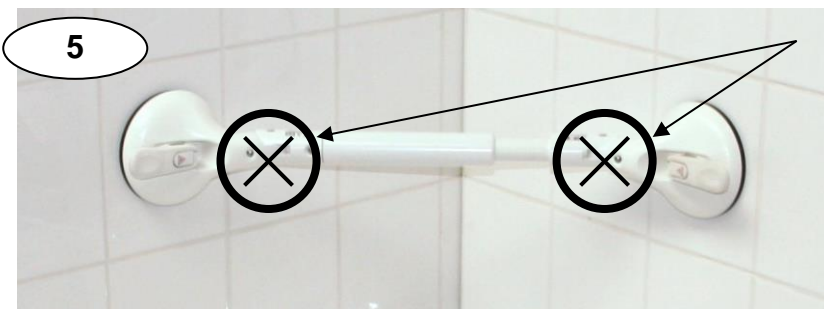

**Attention! Danger of crushing (squeezing)!
Hold only in the area of the telescopic handle, never in the area of the angle joint adapter.**



3.3 Disassembly

Press in the snap-lock pin of the angle joint adapter of the grab handle (see 6a) and pull it out of the suction head. Then remove the telescope from the angle joint and mount it as described in the instructions for the 1400221-2-3S handlebar and as described in the instructions from the 1400221-2-3S Handle specified assemble.

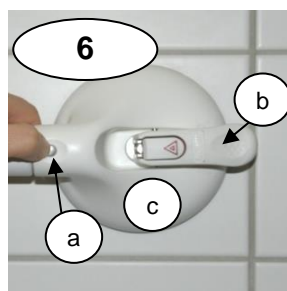

4. Technical data

4.1 Markings on the product (for explanations of the symbols, see page 2)



It is essential to observe the marking on the handlebar and to ensure that the maximum user weight of the handlebars is reduced to 75 kg when using the angle joint adapter!

4.2 Dimensions and weights

The angle joint adapter pair weighs 192 grams together. The total length of the grab handle is extended by 170 mm.

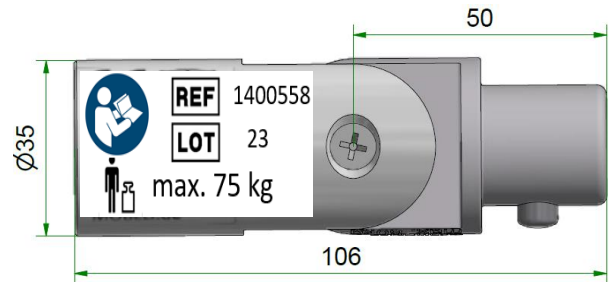

4.3 Materials

Metal parts made of stainless steel; plastic parts made of POM

5. Maintenance

5.1 Maintenance (cleaning/disinfection)

- The grab bar is resistant to the active agents in the hand and surface disinfectants certified by the DGHM (Disinfection Commission of the German Society for Hygiene and Microbiology) with the exception of phenol ether, pyridine derivative and thiocyanate.
- Clean them with standard household cleaning agents like soapy water. Make sure to thoroughly remove any soap or foam residue after use, e.g. after showering (otherwise rust can adhere to the stainless-steel parts).
- Do not use abrasive or aggressive cleaning agents, under no circumstances thinner or petrol.
- Do not use detergents that attack plastics.

5.2 Maintenance (service)

Check the angle joint adapter (regularly) for damage and do not use the damaged parts.

6. Malfunctions (see the instructions for use for the respective grab handles)

7. Disposal

The product packaging should be recycled. The metal parts can be recycled as scrap metal. Disposal must be carried out according to the respective national statutory regulations. Please ask your local or communal authority about local disposal facilities.

These ROTH mobile grab handles may not be exported to the U.S. (cf. U.S. version).

Subject to technical modification.

A brand of



MOBELI®

ROTH® Sanitärprogramme GmbH
D-72213 Altensteig
Kohlbergstraße 5
Tel.: (+49) 07453/9381-0 Fax - 23
eMail: info@mobeli.de
Internet: www.mobeli.de